

# Fast Frame Instructions

## In-Line Connector Frame to End Cap

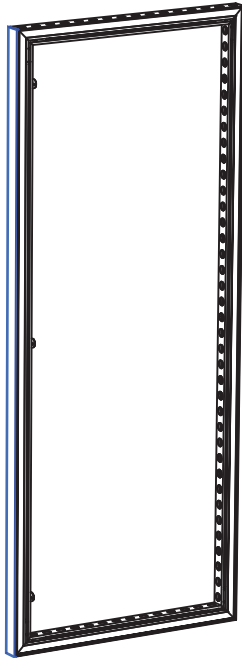

End cap cover, shown in **blue**, to cover holes in the frame.

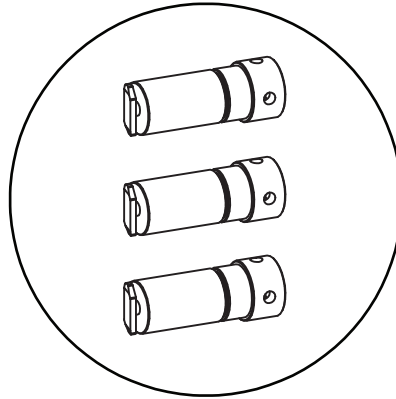

1.

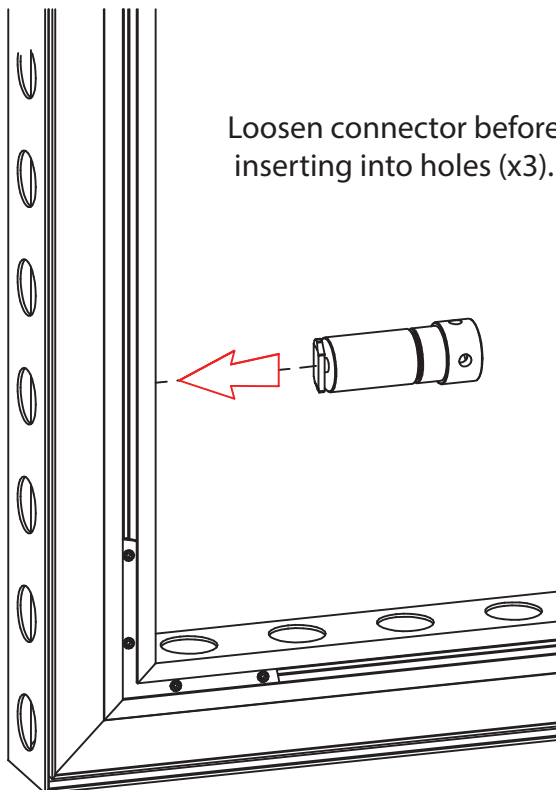

Loosen connector before  
inserting into holes (x3).

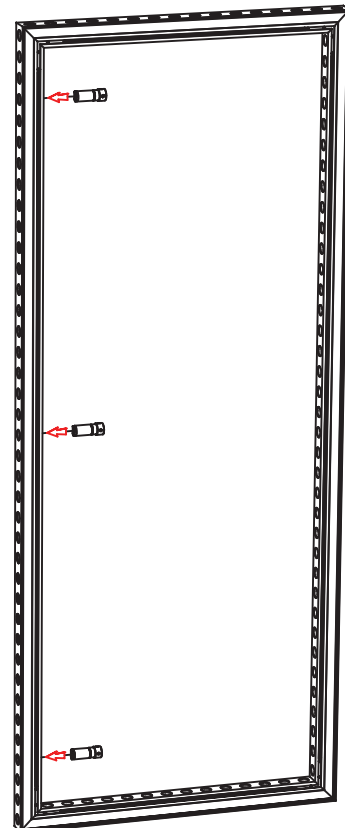

# Fast Frame Instructions

## In-Line Connector Frame to End Cap

2.

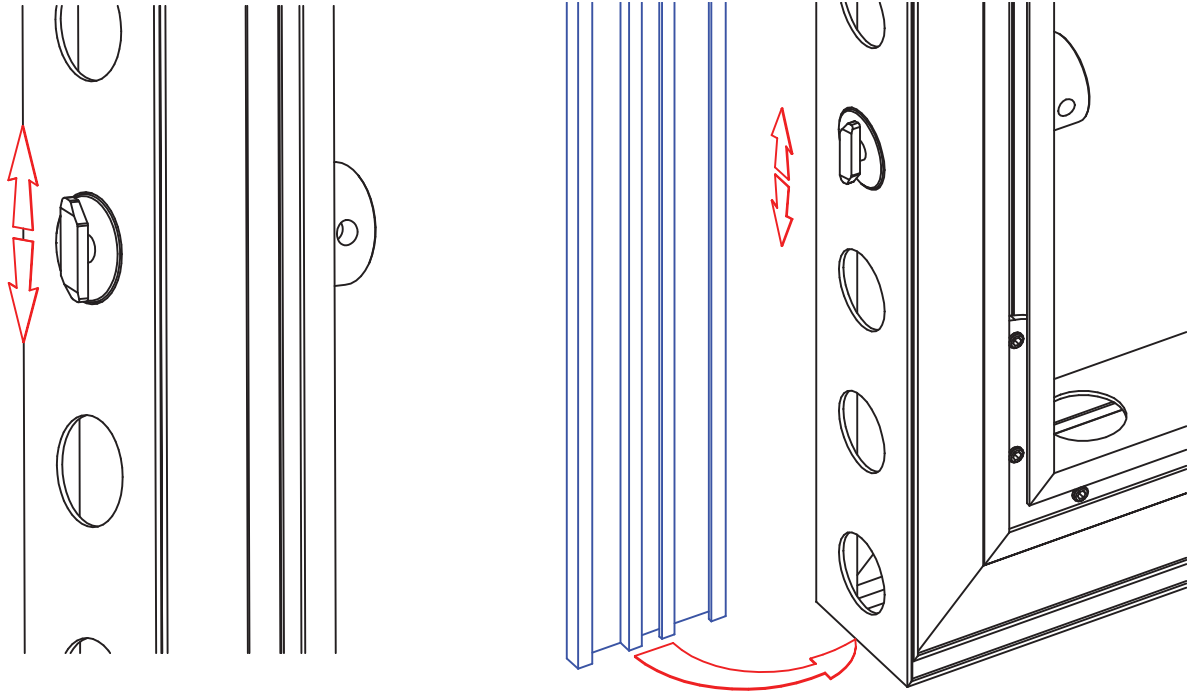

**Connector orientation:** foot  
is aligned up and down (x3)

Put end cap over holes to be hidden.

3.

Align cap (**blue**) with the  
edge of frame.

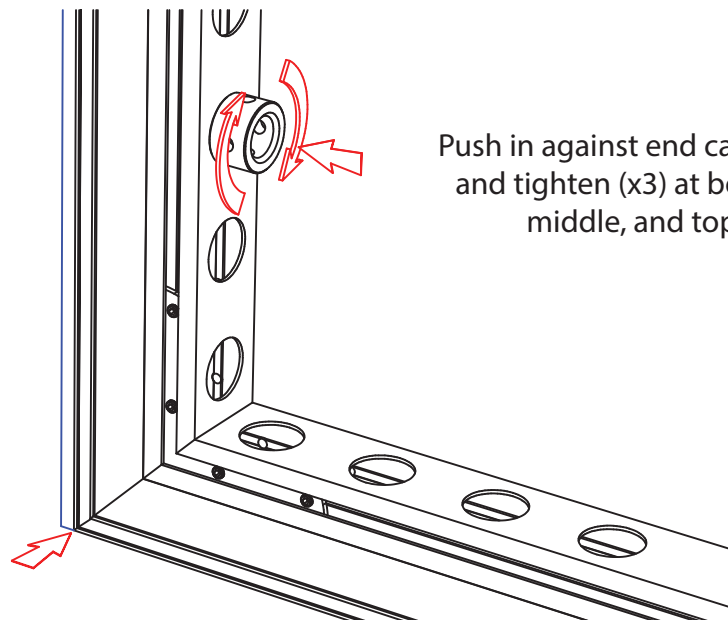

Push in against end cap cover  
and tighten (x3) at bottom,  
middle, and top.